

Florida. American  
 and persons on  
 ion could have  
 ant to 47 C.F.R.  
 oric or cultural  
 n the National  
 may comment  
 submitting an  
 per comments  
 Environmental  
 1801. Requests  
 l and historic/  
 received on or  
 2019, AD#VMOH

**WAKULLA  
 LOWING:**

Meeting

9

Arran  
 orida  
 ng

Contact:

Rd  
 26

8, 2019 AD#VO5S

**Board  
 oners  
 er to  
 trial  
 ority**

Commissioners  
 wakulla County  
 Committee  
 ancing and  
 rojects and  
 f the County.  
 o must be a

Interest in  
 t Authority,  
 ie, address,  
 is no later  
 send your  
 ett, Senior  
 ail to 3093  
 32327 or by  
 019 AD#VO58

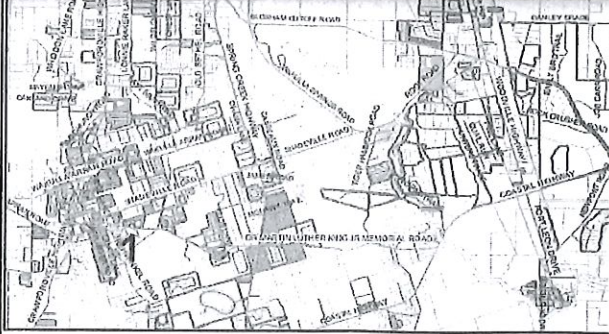

**1. Application for Change of Zoning: R19-02**

Applicant: Golden Construction Company, Inc  
 Tax ID Number: 00-00-071-000-10146-007  
 Existing FLU Map: Urban Fringe (FLUE Policy 1.2.7)  
 Current zoning: RR5 (Section 5-26, LDC) and RR1 (Section 5-27, LDC)  
 Proposed zoning: LDR (Section 5-68, LDC)  
 FEMA Flood Info: "X" and "A" zones on Panel 0250E  
 Parcel size: 16.89+/- acres  
 Location: west of 110 Alexander Road

**Hearings Required:**  
**Planning Commission March 11, 2019 @ 7:00 PM**  
**BOCC Monday April 1, 2019 @ 5:00 PM**

**AN ORDINANCE AMENDING THE WAKULLA COUNTY LAND DEVELOPMENT CODE, ORDINANCE NO. 85-4, AS AMENDED; CHANGING THE ZONING DISTRICT CLASSIFICATION AND OFFICIAL ZONING ATLAS FROM RR5 AND RR1 TO LDR FOR PROPERTY DESCRIBED AS ATTACHED EXHIBIT "A" TO THE ORDINANCE; REPEALING ALL ORDINANCES, OR PORTIONS THEREOF, IN CONFLICT HERewith; PROVIDING FOR SEVERABILITY; PROVIDING FOR AN EFFECTIVE DATE.**

**2. Application for Change of Zoning: R19-03**

Applicant: Golden Construction Company, Inc  
 Tax ID Number: 33-2S-01E-000-04994-000  
 Existing FLU Map: Rural 2 (FLUE Policy 1.2.5)  
 Current zoning: Agriculture (Section 5-25, LDC)  
 Proposed zoning: RR2 (Section 5-34, LDC) and C2 (Section 5-38, LDC)  
 FEMA Flood Info: "X" zone on Panel 0125E  
 Parcel size: 16.72+/- acres  
 Location: east side of Woodville Highway, north of Commerce Boulevard

**Hearings Required:**  
**Planning Commission March 11, 2019 @ 7:00 PM**  
**BOCC Monday April 1, 2019 @ 5:00 PM**

**AN ORDINANCE AMENDING THE WAKULLA COUNTY LAND DEVELOPMENT CODE, ORDINANCE NO. 85-4, AS AMENDED; CHANGING THE ZONING DISTRICT CLASSIFICATION AND OFFICIAL ZONING ATLAS FROM AG TO RR2 AND C2 FOR PROPERTY DESCRIBED AS ATTACHED EXHIBIT "A" TO THE ORDINANCE; REPEALING ALL ORDINANCES, OR PORTIONS THEREOF, IN CONFLICT HERewith; PROVIDING FOR SEVERABILITY; PROVIDING FOR AN EFFECTIVE DATE.**

Copies of applications, draft ordinances, and any related public record files may be viewed at the County Planning Department located at 11 Bream Fountain Road, Crawfordville, FL 32327, 8 AM to 4:30 PM M/F; Phone (850) 926-3695. Any person desiring to appeal a decision of a County Board must ensure a verbatim transcript or copy is made of the testimony and exhibits presented at said hearings. Persons with a disability needing a special accommodation should contact the Wakulla County Board of County Commissioners Administration Office at least two (2) days prior to the meeting at (850) 926-0919; Hearing and Voice Impaired at 1-800-955-8771; or email at ADARrequest@mywakulla.com

**NOTICE OF PUBLIC  
 HEARING CONCERNING  
 AN APPLICATION  
 FOR FINAL PLAT**

The Wakulla County Planning Commission and the Board of County Commissioners propose to consider the following application. A Public Hearing scheduled regarding the following before the Planning Commission on **Monday March 11, 2019 and before the Board of County Commissioners on Monday, April 1, 2019 at 5:00 PM unless otherwise noted below or as time permits.** All public hearings are held at the County Commission Chambers located west of the County Courthouse at 29 Arran Road, Crawfordville, Florida, 32327. Interested parties are invited to attend and present testimony.

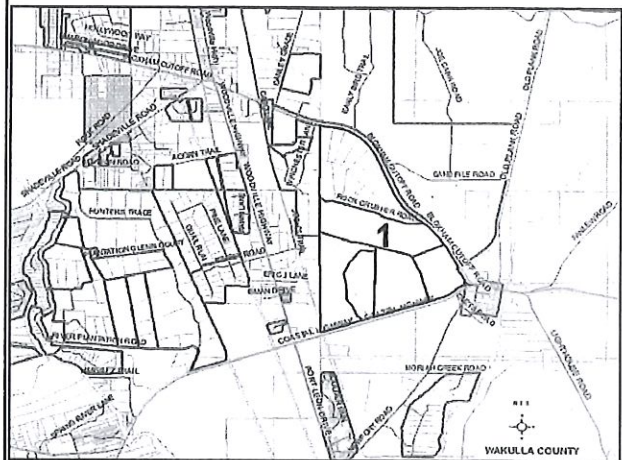

**7. Application for Final Plat Approval: FP19-01**

Applicant: Lynniam Farms, LLC  
 Agent: Edwin Brown & Associates, Inc  
 Proposal: Replat Lots 3, 4 and 5 of Newport Lands & create 23 Lot subdivision  
 Tax ID Number(s): 23-3S-01E-355-05416-005; 23-3S-01E-355-05416-004; 23-3S-01E-355-05416-003  
 Existing FLU Map: AG (FLUE Policy 1.2.3)  
 Current zoning: AG (Section 5-25, LDC)  
 FEMA Flood Info: "X" and "AE" zones on Panel 0275E  
 Parcel size: 612.63+/- acres  
 Location: lying between Bloxham Cutoff Road & Coastal Highway

**Hearings Required:**  
**Planning Commission Monday March 11, 2019 @ 7:00 PM**  
**BOCC Monday April 1, 2019 @ 5:00 PM**

Copies of applications, draft ordinances, and any related public record files may be viewed at the County Planning Department located at 11 Bream Fountain Road, Crawfordville, FL 32327, 8 AM to 4:30 PM M/F; Phone (850) 926-3695. Any person desiring to appeal a decision of a County Board must ensure a verbatim transcript or copy is made of the testimony and exhibits presented at said hearings. Persons with a disability needing a special accommodation should contact the Wakulla County Board of County Commissioners Administration Office at least two (2) days prior to the meeting at (850) 926-0919; Hearing and Voice Impaired at 1-800-955-8771; or email at ADARrequest@mywakulla.com