



WAKULLA
C O U N T Y

**BOARD OF
COUNTY COMMISSIONERS**

Ralph Thomas
Chairman, District 1

Charles Hess, Ph.D.
Vice-Chairman, District 5

Randy Merritt
District 2

Mike Stewart
District 3

Jerry Moore
District 4

J. David Edwards
County Administrator

Heather J. Encinosa
County Attorney
(850) 224-4070

Planning and Community
Development
3093 Crawfordville Hwy
Crawfordville, FL 32327
(850) 926-3695
(850) 926-1528

August 17, 2018

Ralph Pigott III
12 Shar Mel Re Lane
Crawfordville, FL 32327

Re: SP18-22 Pigott Asphalt office and shop

Dear Applicant:

After reviewing the above referenced Application for Site Plan Approval, staff has determined that the development plans comply with the standards set forth in the Wakulla County Land Development Code and is hereby approved on August 17, 2018.

This approval is for the construction of an office and shop for Pigott Asphalt, as shown on the site plan drawing prepared by Hydra Engineering & Construction, LLC, dated August 10, 2018, on an 8.38+/- acre parcel of land, located on the south side of Dr. Martin Luther King Jr. Memorial Boulevard, east of County Landfill Road. Future additions to the Subject Property or expansions must comply with applicable sections of the Wakulla County Code and Wakulla County Comprehensive Plan.

Please be aware that as a condition of approval, all other applicable state or federal permits must be obtained before development commences. The issuance of a local permit does not in any way create any right on the part of an applicant to obtain a permit from a state or federal agency and does not create any liability on the part of the county or municipality for issuance of the permit if the applicant fails to obtain requisite approvals or fulfill the obligations imposed by a state or federal agency or undertakes actions that result in a violation of state or federal law.

An appeal of this decision made by any aggrieved person must be filed within 30 days from the effective date of said decision for review of same in accordance with applicable provisions Section 3-23, Wakulla County Land Development Code.

Please be advised, any actions taken by you in reliance upon the County's decision prior to the expiration of the appeal period is solely at your own risk. If an appeal of the County's decision is filed, all work in reliance upon said decision, must be stopped at the project site until the appeal runs its course. The Department of Planning & Community Development will advise you of any appeals filed by a third party against your proposed application once they were received by that office.

The application, staff report, and related materials may be inspected by the public at the Planning and Community Development Department, located at 3093 Crawfordville Highway, Crawfordville, Florida 32327. If you have any further questions regarding this matter, please feel free to contact this Department.

Sincerely,

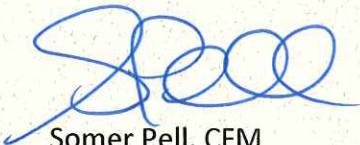
A handwritten signature in blue ink, appearing to read 'Somer Pell', with a stylized, cursive script.

Somer Pell, CFM
Director
Planning and Community Development

Attachment: Location Map

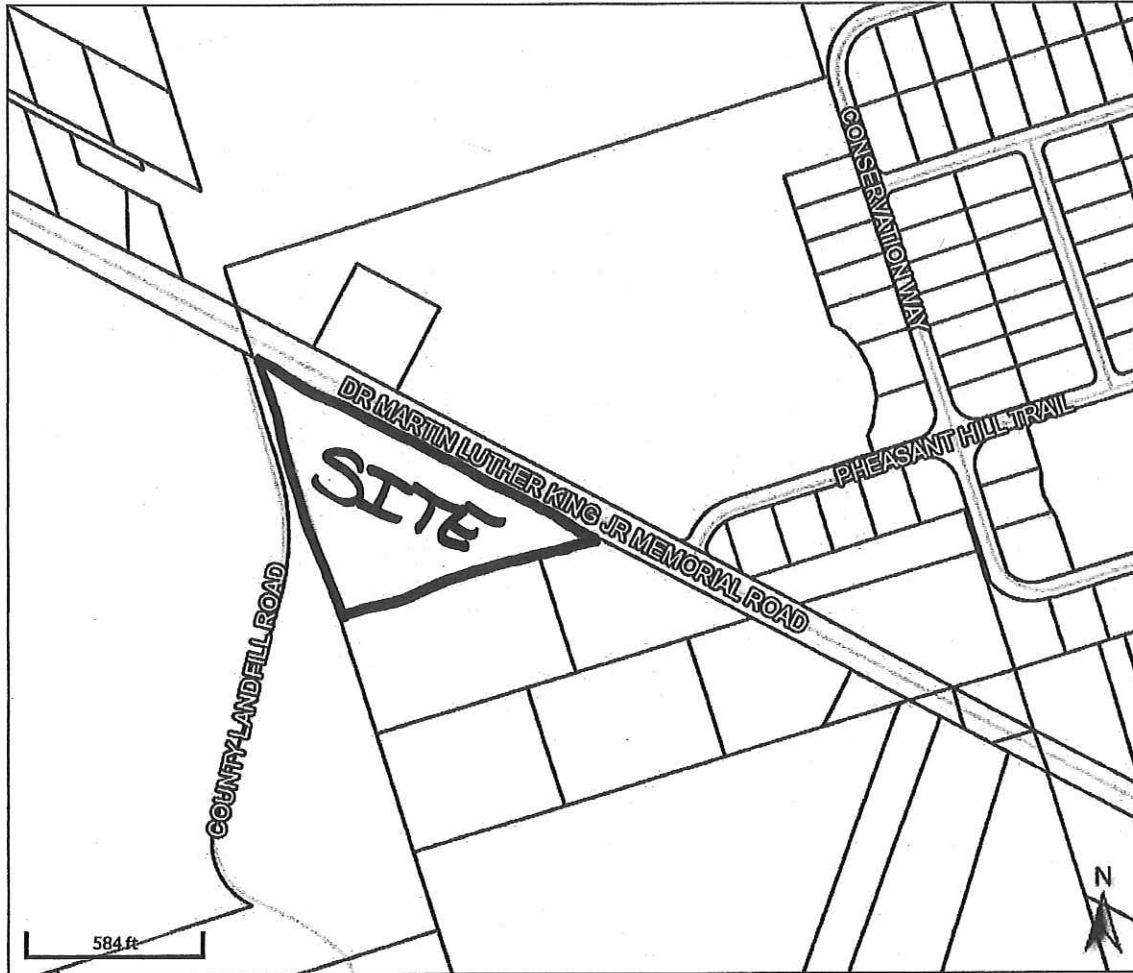

Overview

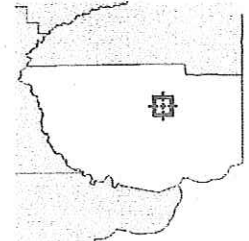

Legend

-  Parcels
-  Roads
-  City Labels

Parcel ID	00-00-053-000-09903-000	Alternate ID	09903 0000000 053000	Owner Address	PIGOTT RALPH F III
Sec/Twp/Rng	--53	Class	TIMBERLAND		12 SHAR MEL RE LN
Property Address	DR MARTIN LUTHER KING JR RD	Acreage	8.38		CRAWFORDVILLE, FL 32327
District	3				
Brief Tax Description	LOT 53 HS P-4-M-14 (Note: Not to be used on legal documents)				

Date created: 8/1/2018
 Last Data Uploaded: 7/31/2018 10:09:21 PM

Developed by  **Schneider**
 GEOSPATIAL