

October 13, 2017

Little Salem Primitive Baptist Church
P O Box 543
Crawfordville, FL 32327

Re: SP17-20 Addition of portico/reconfigure parking

**BOARD OF
COUNTY COMMISSIONERS**

Ralph Thomas
Chairman, District 1

Mike Stewart
Vice-Chairman, District 3

Randy Merritt
District 2

Jerry Moore
District 4

Charles Hess, Ph.D.
District 5

J. David Edwards
County Administrator

Heather J. Encinosa
County Attorney
(850) 224-4070

Dear Applicant:

After reviewing the above referenced Application for Site Plan Approval, staff has determined that the revisions to the development plans comply with the standards set forth in the Wakulla County Land Development Code and is hereby approved on October 13, 2017.

This approval is for the addition of a portico and to reconfigure 2 parking spaces, as shown on the site plan drawing prepared by Hydra Engineering & Construction, LLC dated September 27, 2017, on a 22+/- acre parcel of land, located at 1998 Wakulla Arran Road. Future additions to the Subject Property or expansions must comply with applicable sections of the Wakulla County Code and Wakulla County Comprehensive Plan.

Please be aware that as a condition of approval, all other applicable state or federal permits must be obtained before development commences. The issuance of a local permit does not in any way create any right on the part of an applicant to obtain a permit from a state or federal agency and does not create any liability on the part of the county or municipality for issuance of the permit if the applicant fails to obtain requisite approvals or fulfill the obligations imposed by a state or federal agency or undertakes actions that result in a violation of state or federal law.

An appeal of this decision made by any aggrieved person must be filed within 30 days from the effective date of said decision for review of same in accordance with applicable provisions Section 3-23, Wakulla County Land Development Code.

Please be advised, any actions taken by you in reliance upon the County's decision prior to the expiration of the appeal period is solely at your own risk. If an appeal of the County's decision is filed, all work in reliance upon said decision, must be stopped at the project site until the appeal runs its course. The Department of Planning & Community Development will advise you of any appeals filed by a third party against your proposed application once they were received by that office.

Planning and Community
Development
3093 Crawfordville Hwy
Crawfordville, FL 32327
(850) 926-3695
(850) 926-1528

The application, staff report and related materials may be inspected by the public at the Planning and Community Development Department, located at 3093 Crawfordville Highway, Crawfordville, Florida 32327. If you have any further questions regarding this matter, please feel free to contact this Department.

Sincerely,

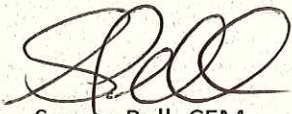
A handwritten signature in black ink, appearing to read 'S. Pell', written in a cursive style.

Somer Pell, CFM

Director

Planning and Community Development

Attachment: Location Map

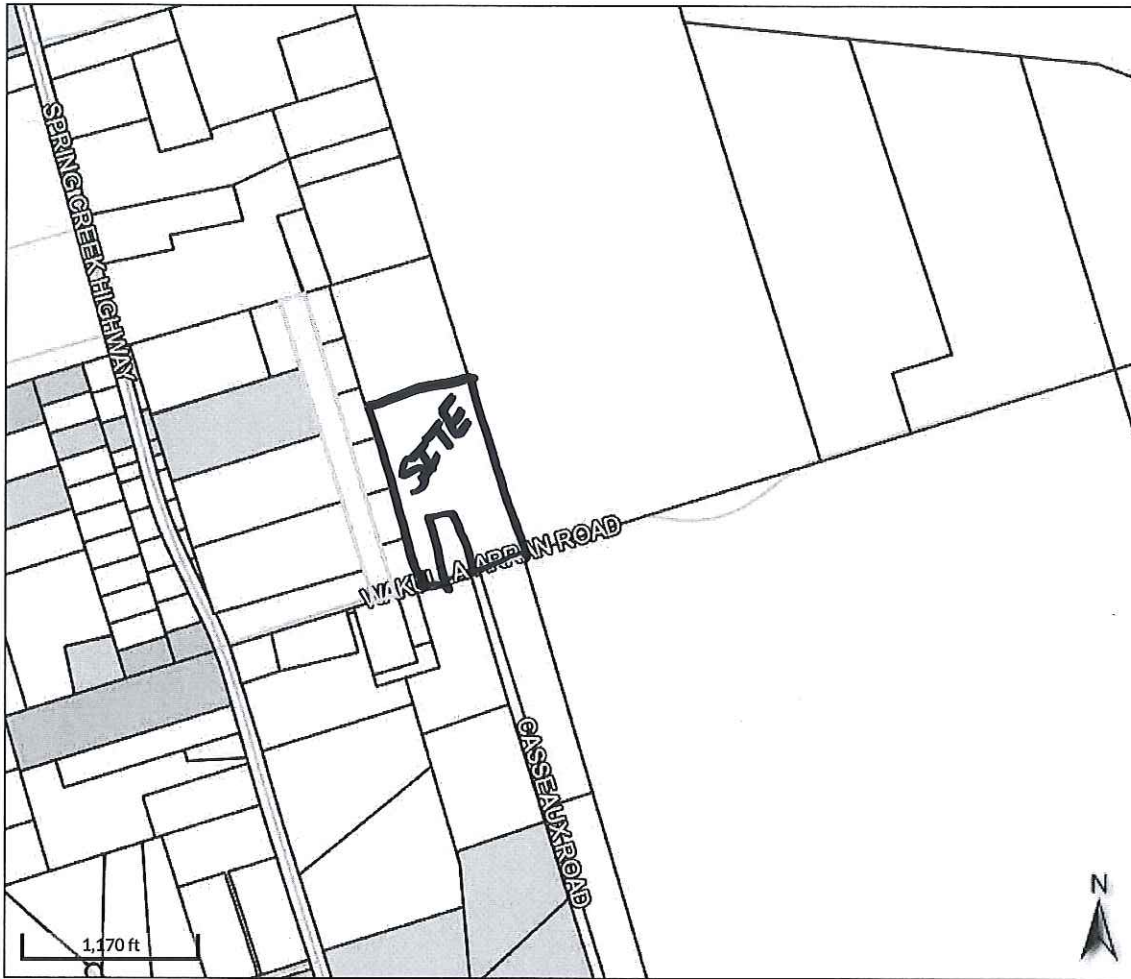

Overview

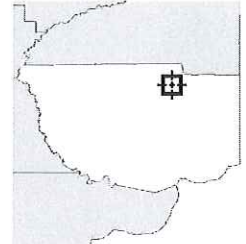

Legend

-  Parcels
- Yearly Sales**
-  2015
-  2016
-  2017
-  Roads
-  City Labels

Parcel ID	00-00-038-000-09765-000	Alternate ID	09765 0000000 038000	Owner Address	CHURCH LITTLE SALEM PRIMITIVE
Sec/Twp/Rng	--38	Class	CHURCHES		BAPTIST
Property Address	1998 WAKULLA ARRAN RD	Acreage	22		P O BOX 543
					CRAWFORDVILLE, FL 323260543
District	3				
Brief Tax Description	LOT 38 HS P-30-M-9 (Note: Not to be used on legal documents)				

Date created: 9/28/2017
 Last Data Uploaded: 9/27/2017 8:26:48 PM

 Developed by
 The Schneider Corporation