



October 19, 2017

Wakulla County
P. O. Box 1263
Crawfordville, FL 32326
Re: SP17-15 Construct new EMS facility

**BOARD OF
COUNTY COMMISSIONERS**

Ralph Thomas
Chairman, District 1

Mike Stewart
Vice-Chairman, District 3

Randy Merritt
District 2

Jerry Moore
District 4

Charles Hess, Ph.D.
District 5

J. David Edwards
County Administrator

Heather J. Encinosa
County Attorney
(850) 224-4070

Planning and Community
Development
3093 Crawfordville Hwy
Crawfordville, FL 32327
(850) 926-3695
(850) 926-1528

Dear Applicant:

After reviewing the above referenced Application for Site Plan Approval, staff has determined that the revisions to the development plans comply with the standards set forth in the Wakulla County Land Development Code and is hereby approved on October 18, 2017.

This approval is for the construction of a new Fire/EMS Facility, as shown on the site plan drawing prepared by Dewberry/Preble-Rish, dated October 13, 2017, on a 4.54+/- acre parcel of land, located at 318 Trice Lane. Future additions to the Subject Property or expansions must comply with applicable sections of the Wakulla County Code and Wakulla County Comprehensive Plan.

Please be aware that as a condition of approval, all other applicable state or federal permits must be obtained before development commences. The issuance of a local permit does not in any way create any right on the part of an applicant to obtain a permit from a state or federal agency and does not create any liability on the part of the county or municipality for issuance of the permit if the applicant fails to obtain requisite approvals or fulfill the obligations imposed by a state or federal agency or undertakes actions that result in a violation of state or federal law.

An appeal of this decision made by any aggrieved person must be filed within 30 days from the effective date of said decision for review of same in accordance with applicable provisions Section 3-23, Wakulla County Land Development Code.

Please be advised, any actions taken by you in reliance upon the County's decision prior to the expiration of the appeal period is solely at your own risk. If an appeal of the County's decision is filed, all work in reliance upon said decision, must be stopped at the project site until the appeal runs its course. The Department of Planning & Community Development will advise you of any appeals filed by a third party against your proposed application once they were received by that office.

The application, staff report and related materials may be inspected by the public at the Planning and Community Development Department, located at 3093 Crawfordville Highway, Crawfordville, Florida 32327. If you have any further questions regarding this matter, please feel free to contact this Department.

Sincerely,

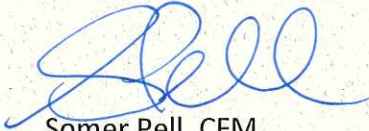

Somer Pell, CFM

Director

Planning and Community Development

Attachment: Location Map

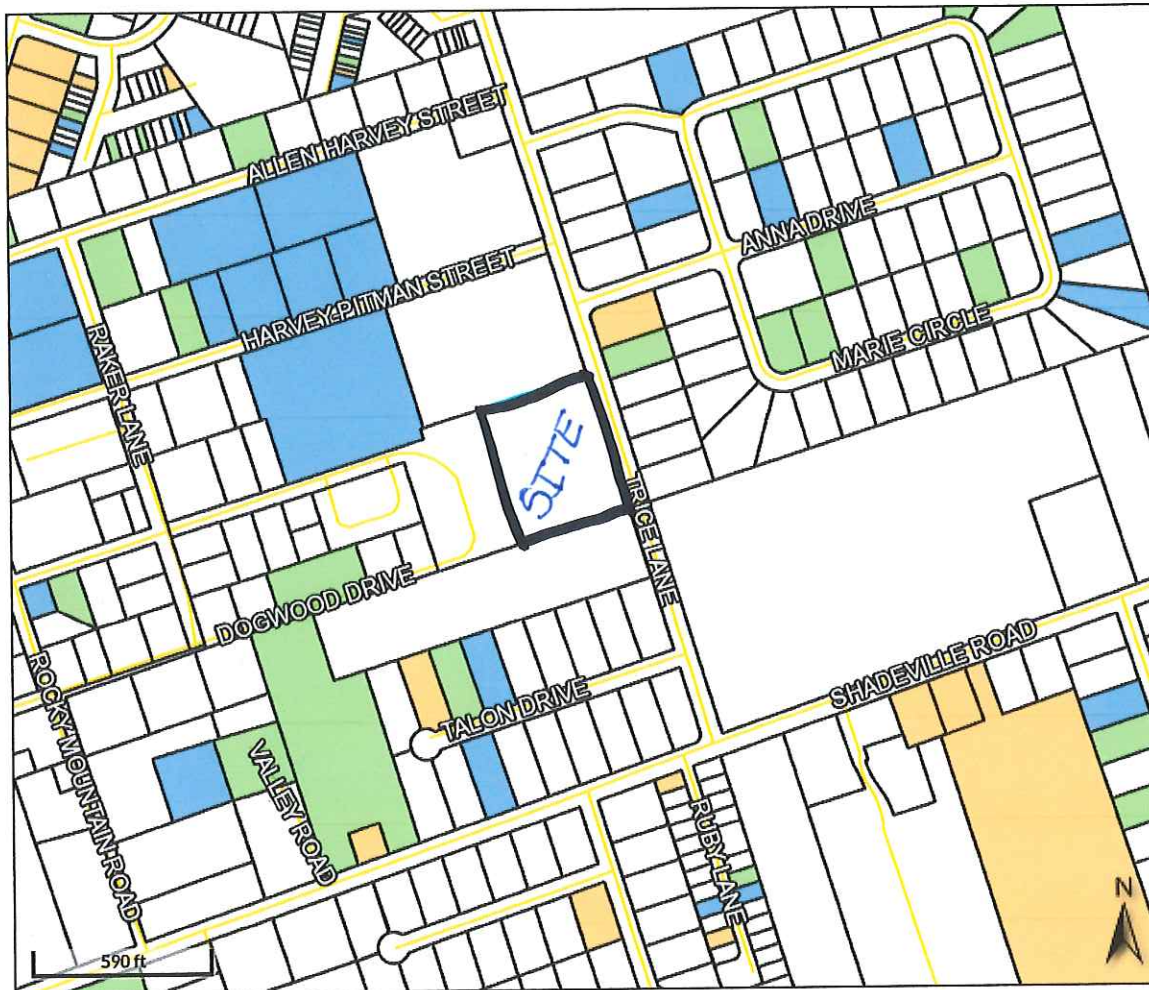

Overview



Legend

-  Parcels
- Yearly Sales**
-  2015
-  2016
-  2017
-  Roads
- City Labels**
- State Outlines**
-  <all other values>
-  Florida

Parcel ID	00-00-076-000-10257-031	Alternate ID	10257 0310000 076000	Owner Address	WAKULLA COUNTY
Sec/Twp/Rng	--76	Class	COUNTY		PO BOX 1263
Property Address	318 TRICELN	Acreage	3.7		CRAWFORDVILLE, FL 32326
District	3				
Brief Tax Description	A PARCEL OF LAND CONT 3.70 AC				
	<i>(Note: Not to be used on legal documents)</i>				

Date created: 8/15/2017
 Last Data Uploaded: 8/14/2017 10:10:48 PM

 Developed by
 The Schneider Corporation

*CA/
 Public*