



Earthworks Geotechnical, Inc.

Providing Environmental, Geotechnical Drilling,
Soil Testing, & Engineering Services

2467 Centerville Road Tallahassee, Florida 32308
(850) 385-5288 Fax (850) 386-7586 ~ dec@nettally.com

SOIL BORING REPORT

JOB NUMBER: 08E-0394	DATE OF TEST: 5/7/2009
CLIENT: Ray Gray	PROJECT LOCATION: Community Center, Crawfordville
TECHNICIAN: MR/AW/JD	EQUIPMENT USED: Hand Auger

BORING NUMBER	DEPTH	SOIL DESCRIPTION (Visually Classified)
1	0 - 1'	Gray fine sand
	1 - 4 1/2'	Brown fine sand
	4 1/2 - 6 1/2'	Pale brown fine sand
	6 1/2 - 9'	White fine sand
	9 - 10'	Yellowish brown very slightly clayey fine sand
2	0 - 1'	Gray fine sand
	1 - 4 1/2'	Brown fine sand
	4 1/2 - 6 1/2'	Pale brown fine sand
	6 1/2 - 9'	White fine sand
	9 - 10'	Yellowish brown very slightly clayey fine sand
3	0 - 2'	Gray moist fine sand with rocks
	2 - 5'	Brown moist fine sand
	5 - 7'	Pale brown moist fine sand
	7 - 9 1/2'	White moist fine sand
	9 1/2 - 10'	Pale reddish brown moist slightly clayey fine sand
4	0 - 1 1/2'	Gray moist fine sand
	1 1/2 - 4'	Brown moist fine sand
	4 - 7 1/2'	Pale brown moist fine sand
	7 1/2 - 10'	White moist fine sand
5	0 - 1 1/2'	Gray fine sand
	1 1/2 - 5'	Pale brown moist fine sand
	5 - 7'	White moist fine sand
	7 - 10'	Reddish brown moist slightly clayey sand
6	0 - 1'	Gray fine sand
	1 - 4 1/2'	Pale brown moist fine sand
	4 1/2 - 6 1/2'	White moist fine sand
	6 1/2 - 9'	Gray/reddish brown moist moderately clayey sand
	9 - 10'	Gray/reddish brown moist sandy clay

- Based on my review the above described soil borings at/near the test areas appear suitable for development and a special foundation is not required.
- Organic material (>2%) should be removed and verified in the above-mentioned borings that contain organic intervals (>2%).
- Shallow GWT encountered, the Client should consult a foundation engineer to determine if a specialized foundation is warranted.
- Due to presence of pipe clay at the test area(s), a specialized foundation is recommended.
- Proposed Home area flagged by Client.
- Low bearing soils encountered within SPT or DCP borings (see attached SPT or DCP form for additional notes).
- No ground water table
- Ground water table encountered

Soil Boring Orientation (NOT TO SCALE):

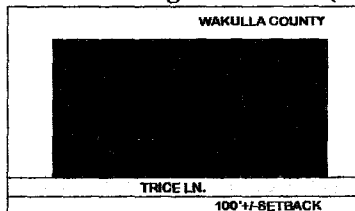

This diagram is a conceptual representation. The diagram should not be considered as an accurate depiction and is for relative position only. The distances are approximate and have not been surveyed. Boring locations are intended to bracket the proposed building site, based on field staking and/or other information provided by the client. Variations in the subsurface conditions may be present between, away from, and around the boring locations and this report does not reflect those variations. If variations are found in the subsurface during construction, it will be necessary to reevaluate the conclusions stated in this report.

5-7-09
DATE

W. E. DOUGLAS, P.E.
Florida Reg. No. 11553



Earthworks Geotechnical, Inc.

Providing Environmental, Geotechnical Drilling,
Soil Testing, & Engineering Services

2467 Centerville Road Tallahassee, Florida 32308
(850) 385-5288 Fax (850) 386-7586 - dec@nettalliv.com

SOIL BORING REPORT

JOB NUMBER: 08E-0394	DATE OF TEST: 5/7/2009
CLIENT: Ray Gray	PROJECT LOCATION: Community Center, Crawfordville
TECHNICIAN: MR/AW/JD	EQUIPMENT USED: Hand Auger

BORING NUMBER	DEPTH	SOIL DESCRIPTION (Visually Classified)
1	0 - 1'	Gray fine sand
	1 - 4 1/2'	Brown fine sand
	4 1/2 - 6 1/2'	Pale brown fine sand
	6 1/2 - 9'	White fine sand
	9 - 10'	Yellowish brown very slightly clayey fine sand
2	0 - 1'	Gray fine sand
	1 - 4 1/2'	Brown fine sand
	4 1/2 - 6 1/2'	Pale brown fine sand
	6 1/2 - 9'	White fine sand
	9 - 10'	Yellowish brown very slightly clayey fine sand
3	0 - 2'	Gray moist fine sand with rocks
	2 - 5'	Brown moist fine sand
	5 - 7'	Pale brown moist fine sand
	7 - 9 1/2'	White moist fine sand
	9 1/2 - 10'	Pale reddish brown moist slightly clayey fine sand
4	0 - 1 1/2'	Gray moist fine sand
	1 1/2 - 4'	Brown moist fine sand
	4 - 7 1/2'	Pale brown moist fine sand
	7 1/2 - 10'	White moist fine sand
5	0 - 1 1/2'	Gray fine sand
	1 1/2 - 5'	Pale brown moist fine sand
	5 - 7'	White moist fine sand
	7 - 10'	Reddish brown moist slightly clayey sand
6	0 - 1'	Gray fine sand
	1 - 4 1/2'	Pale brown moist fine sand
	4 1/2 - 6 1/2'	White moist fine sand
	6 1/2 - 9'	Gray/reddish brown moist moderately clayey sand
	9 - 10'	Gray/reddish brown moist sandy clay

- Based on my review the above described soil borings at/near the test areas appear suitable for development and a special foundation is not required.
- Organic material (>2%) should be removed and verified in the above-mentioned borings that contain organic intervals (>2%).
- Shallow GWT encountered, the Client should consult a foundation engineer to determine if a specialized foundation is warranted.
- Due to presence of pipe clay at the test area(s), a specialized foundation is recommended.
- Proposed Home area flagged by Client.
- Low bearing soils encountered within SPT or DCP borings (see attached SPT or DCP form for additional notes).
- No ground water table
- Ground water table encountered

Soil Boring Orientation (NOT TO SCALE):

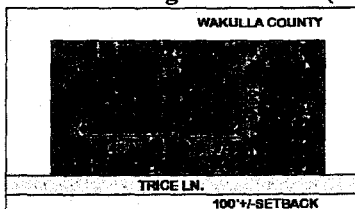

This diagram is a conceptual representation. The diagram should not be considered as an accurate depiction and is for relative position only. The distances are approximate and have not been surveyed. Boring locations are intended to bracket the proposed building site, based on field staking and/or other information provided by the client. Variations in the subsurface conditions may be present between, away from, and around the boring locations and this report does not reflect those variations. If variations are found in the subsurface during construction, it will be necessary to reevaluate the conclusions stated in this report.

5-7-09
DATE

W. E. DOUGLAS, P.E.
Florida Reg. No. 11553